

---

Fitting instructions

---

Make: Hyundai

---

Tucson (JM); 2004->

---

Type: 4303

---

---

Permanently

---

linked to

---

quality

---

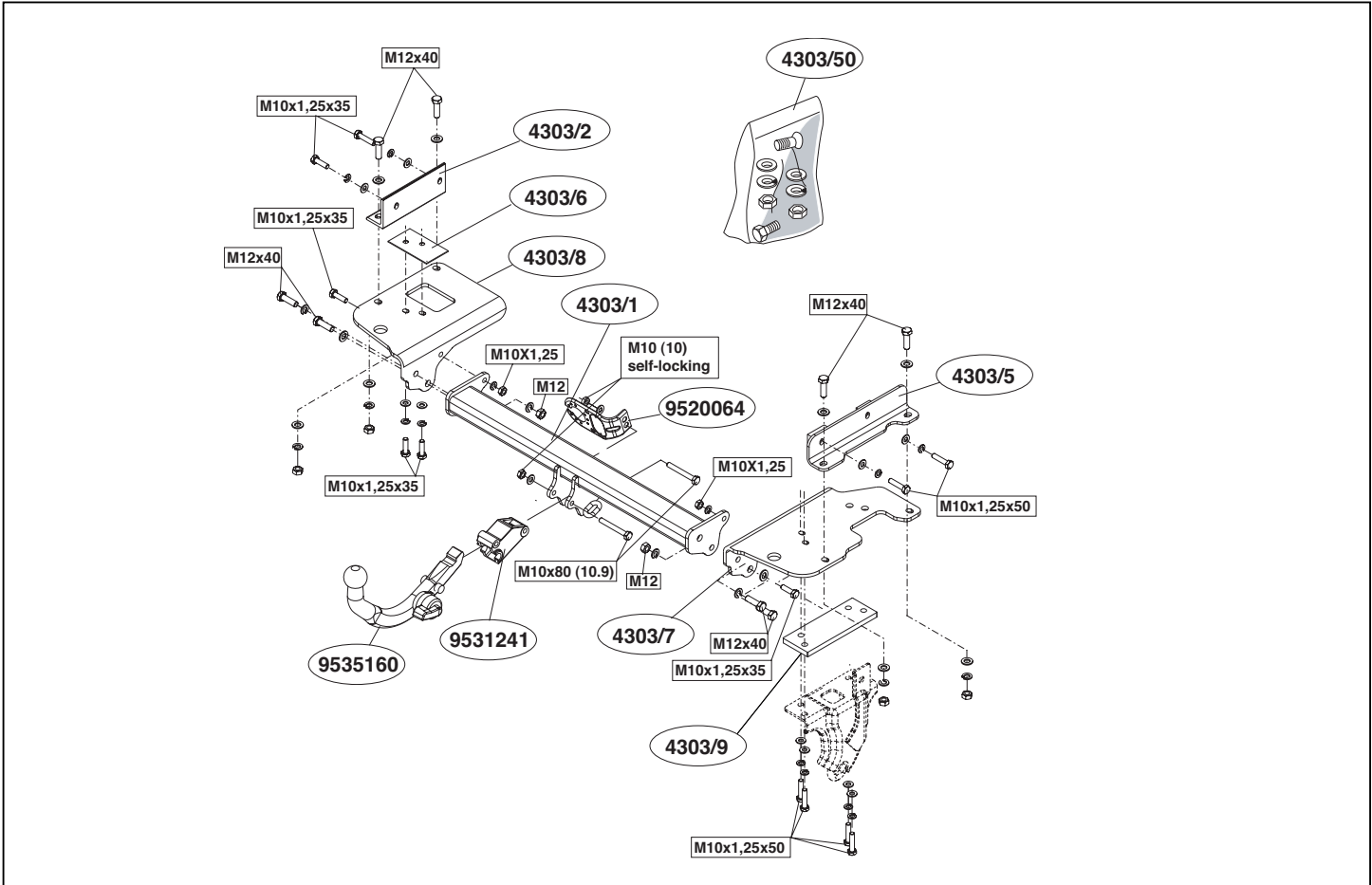

© 430370/20-05-2005/1

Dispositivo di traino tipo:  
Per autoveicoli:  
Tipo funzionale:

Brink 4303  
Hyundai Tucson (JM): 2004->

Classe e tipo di attacco:  
A50-X  
e11 00-4988

Omologazione:  
Valore D:  
9,8 kN

Carico Verticale max. S:  
75 kg

Larghezza rimorchiabile per Caravan e T.A.T.S.: 2,45m vedere CARTA di CIRCOLAZIONE VEICOLO (motrice) + 70 cm = ..arrotondare ai 5 cm

superiore (vedi D.M.28/05/85)

Massa rimorchiabile:  
vedi carta di circolazione dell' autoveicolo

Per verificare l' idoneità del dispositivo di traino omologato a norma CEE 94/20, all' installazione sulla vettura su cui si intende procedere al montaggio, compilare la seguente formula (se necessario)  
declassare la massa rimorchiabile):  
dove: T= Massa Complessiva Max. della motrice (in kg)  
C= Massa Rimorchiabile Max. della motrice (in kg)

$$D = \frac{T + C}{T \times C} \times 0,00981 = \dots\dots\dots \text{KN}$$

**DA COMPILARE PER IL COLLAUDO**

**DICHIARAZIONE DI CORRETTO MONTAGGIO:** la sottoscritta Ditta dichiara di aver montato in maniera corretta ed in conformità alle prescrizioni sia del costruttore del veicolo che del costruttore del dispositivo stesso il seguente dispositivo di attacco meccanico:

**TIMBRO e FIRMA**

tipo:.....  
Il dispositivo di attacco sopra indicato è stato installato su autoveicolo

modello:.....

targa:.....

Data:.....

Si dichiara inoltre di aver informato l'utente del veicolo sull'USO e MANUTENZIONE del dispositivo stesso.

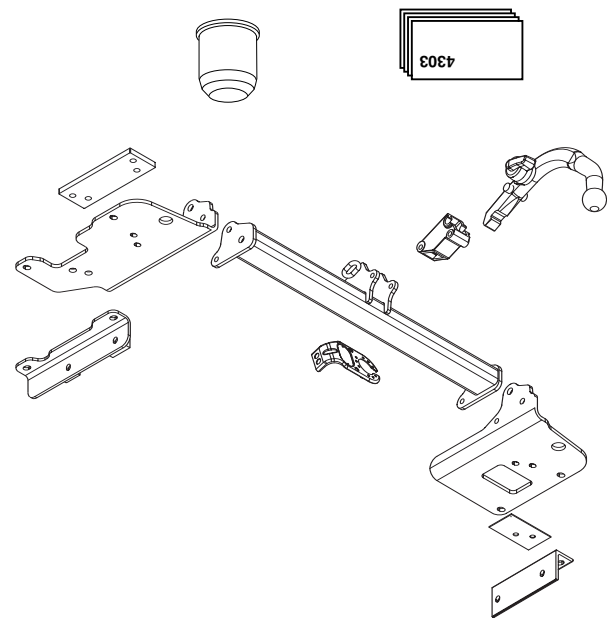
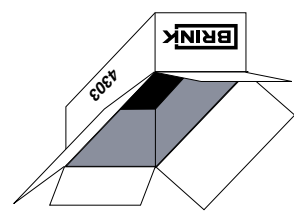

(6x) M10x1,25x35

(6x) M10x1,25x50

(8x) M12x40

(2x) M10x80 (10,9)

(12x) M10

(8x) M12

(12x) M10

(10x) M12

(2x) M10 x1,25

(6x) M12

(2x) M10 (10)  
Self-locking

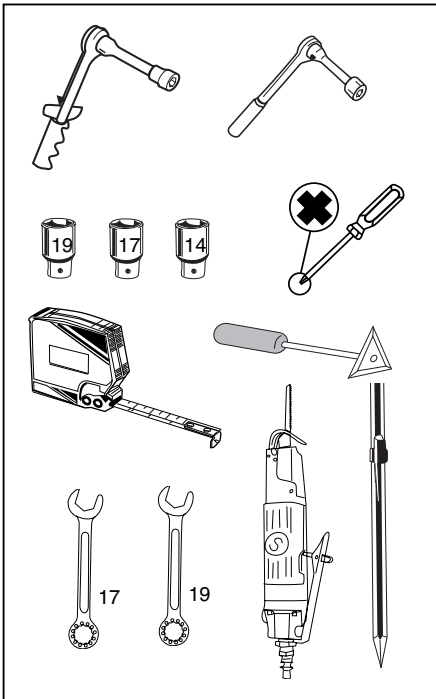

Couplingsclass: A50-X

euro tested

94/20/EC

Approved

e11 00-4988

**D-Value : 9,8 kN**

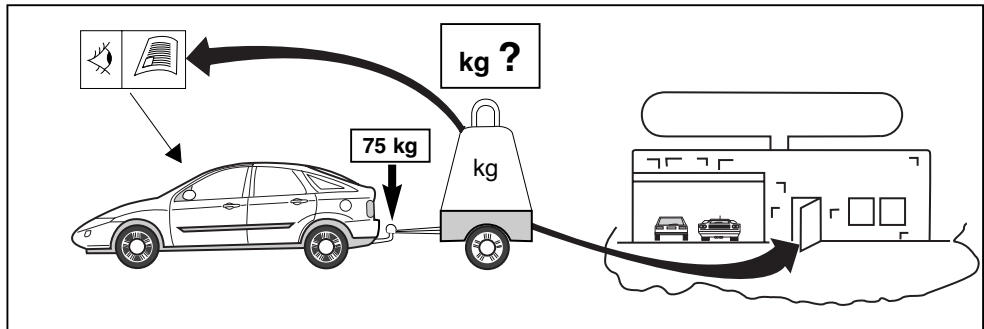

	8.8
	10.9
	8
	10

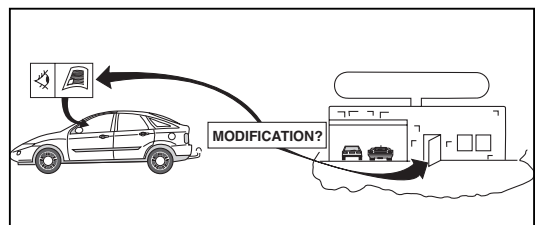

© 430370/20-05-2005/3

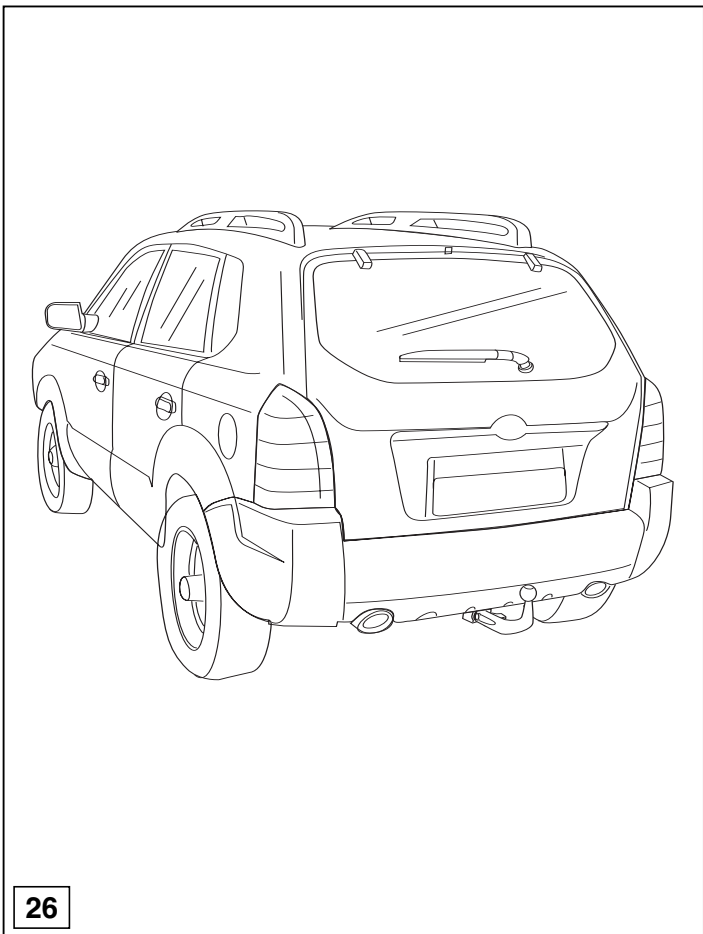



M10 60 Nm (with self-locking nut)

Torque settings for nuts and bolts (10.9)

M12 79 Nm

M10x1,25 53 Nm

Torque settings for nuts and bolts (8.8)

\* Die für das Fahrzeug zugelassene Anhängelast ist den Fahrzeug Unterlagen zu entnehmen. Bei Änderungen des Fahrzeuggewichtes muß die höchstzulässige Anhängelast gegebenenfalls aus dem D-Wert nachgerechnet werden.  
 \* Elektrische Anlage gemäß StVZO anbringen.  
 Auskunft hierüber kann Ihr Fachhändler oder der TÜV geben.

**HINWEISE:**

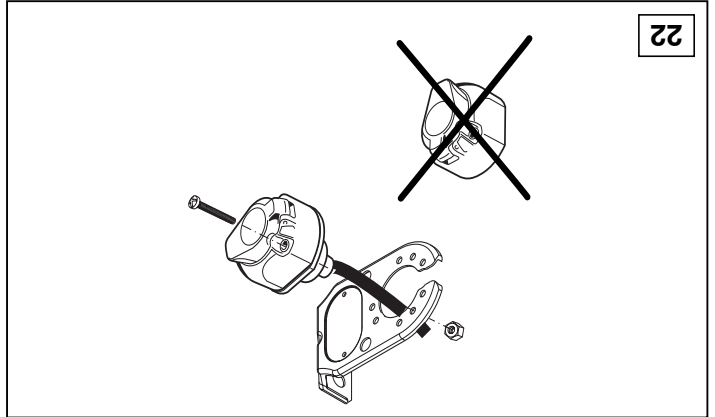
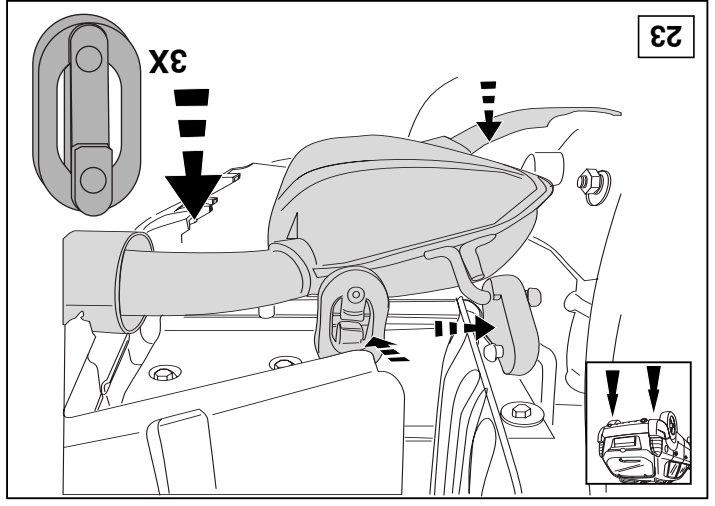
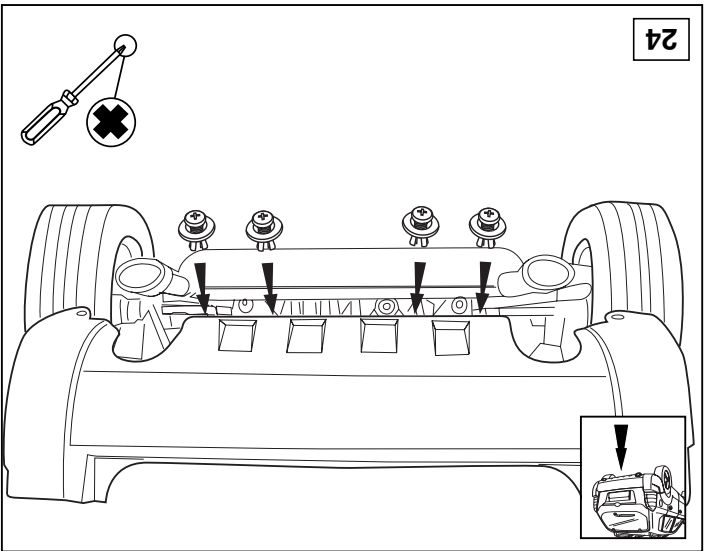
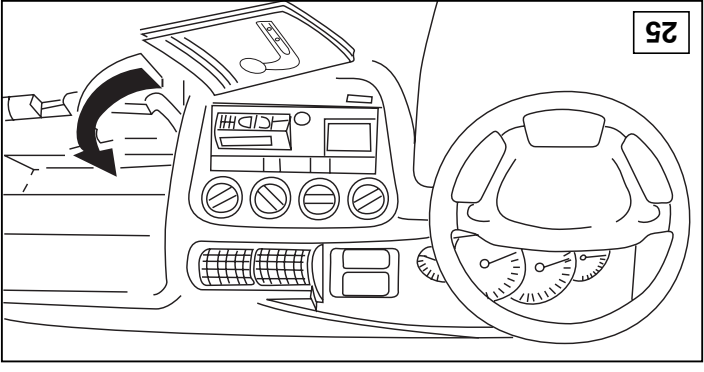

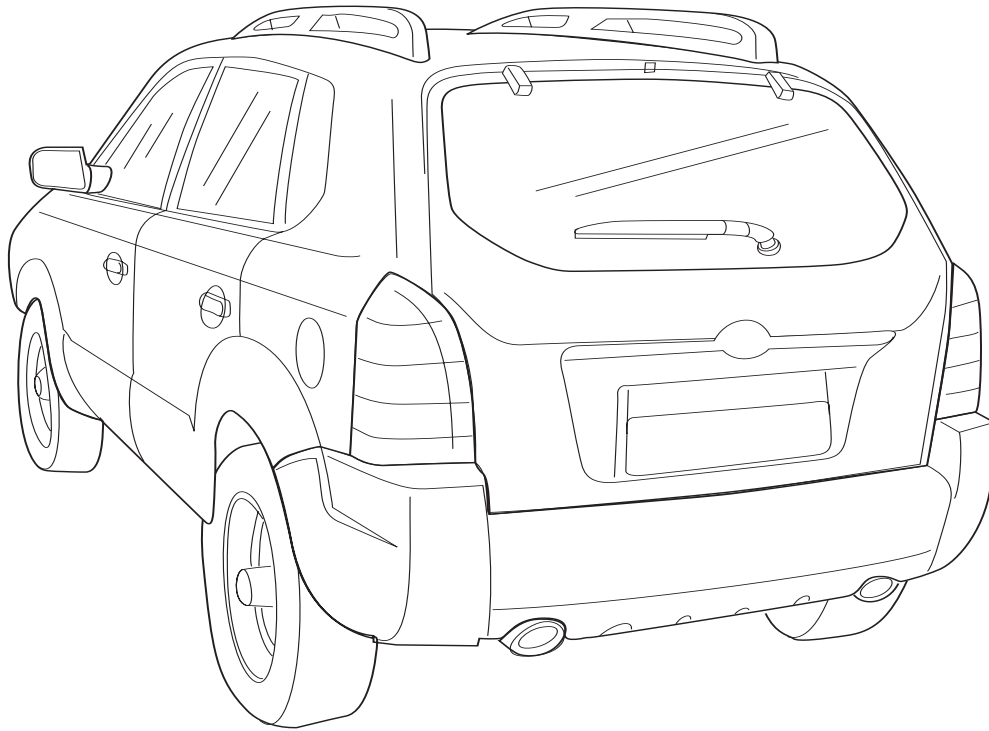

1

© 430370/20-05-2005/5

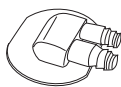

762989

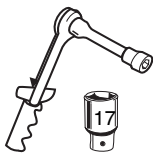

60 Nm



(2x) M10x80  
(10.9)



(2x) M10  
(2x) M10 (10)  
self-locking

M10 (10)  
self-locking

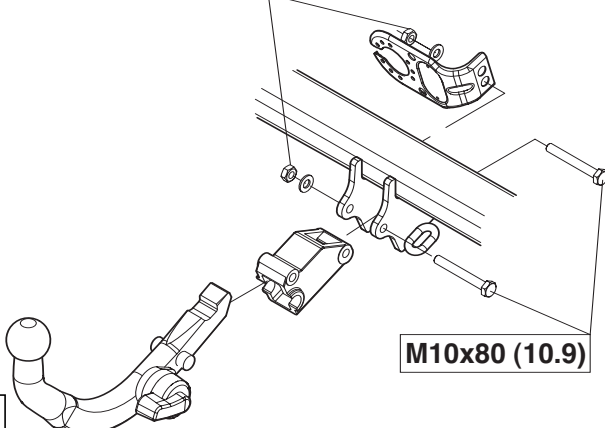

M10x80 (10.9)

20

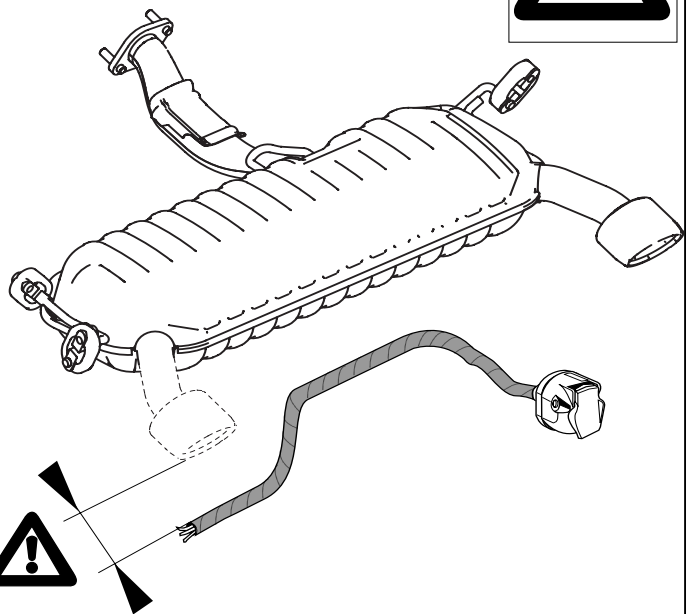

21

© 430370/20-05-2005/14

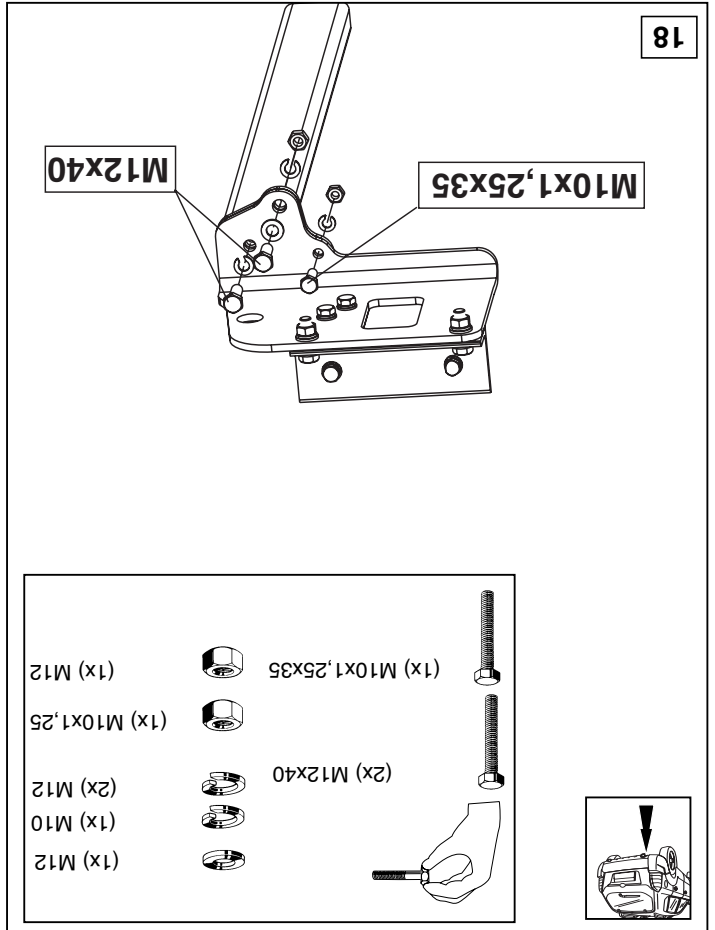
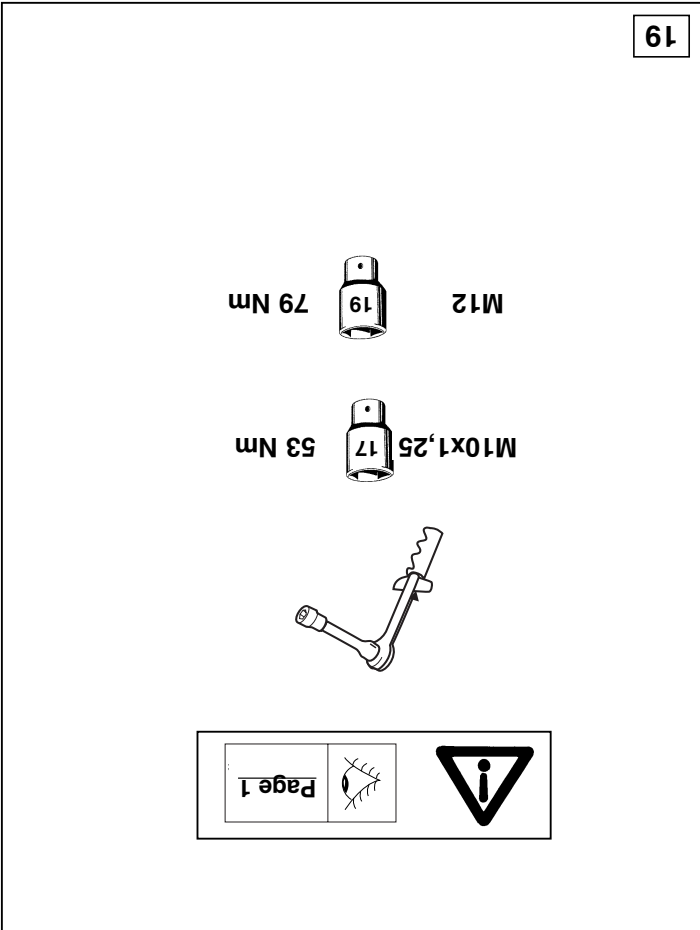
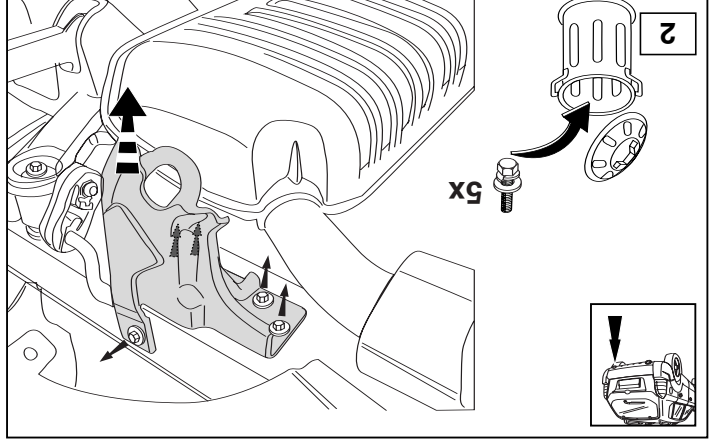
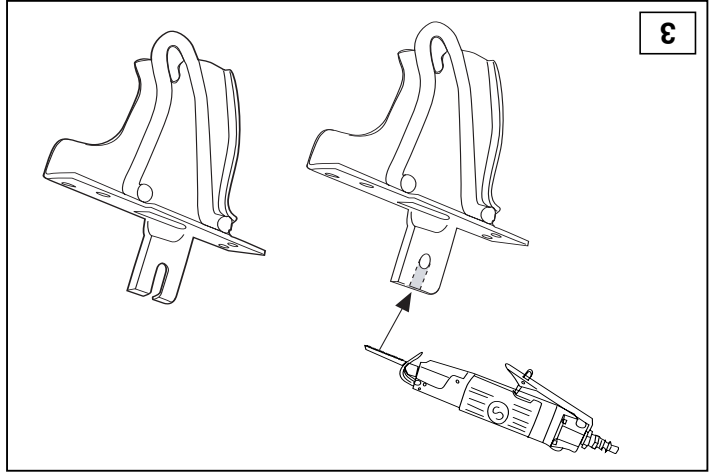
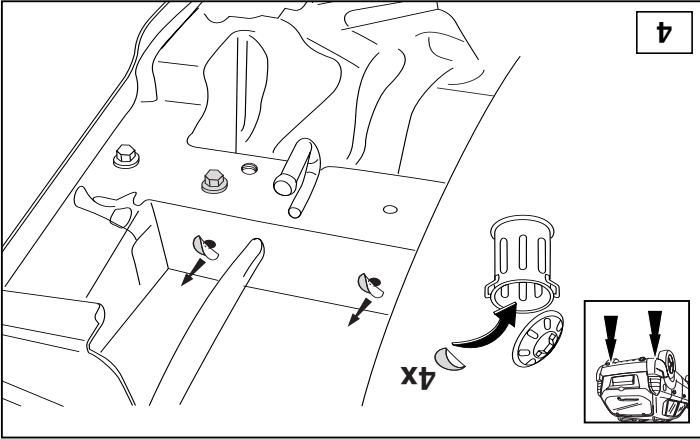
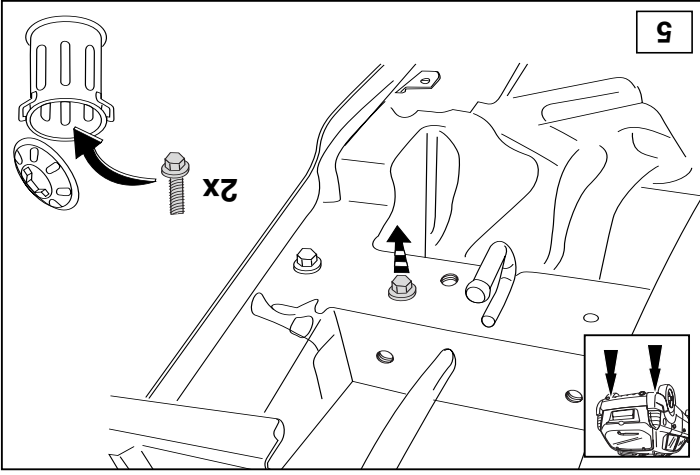

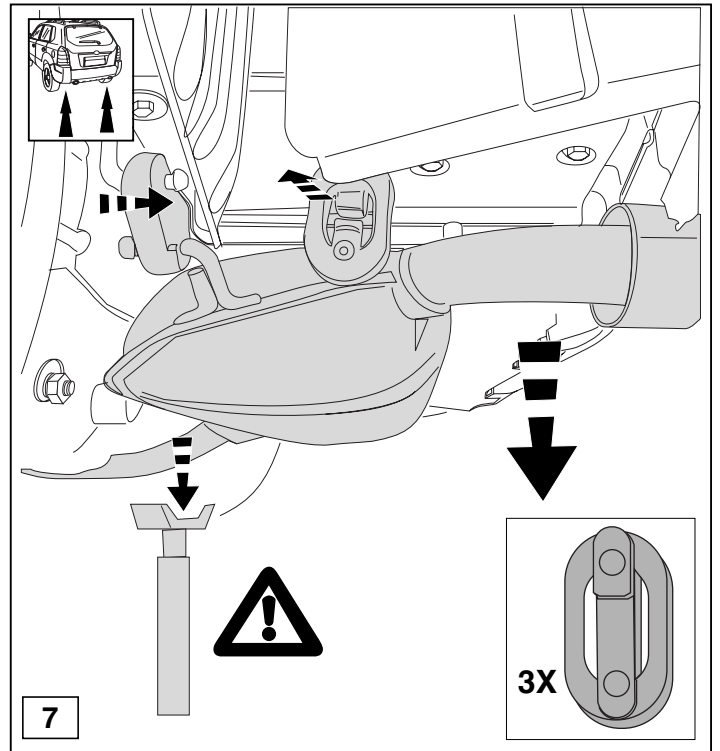
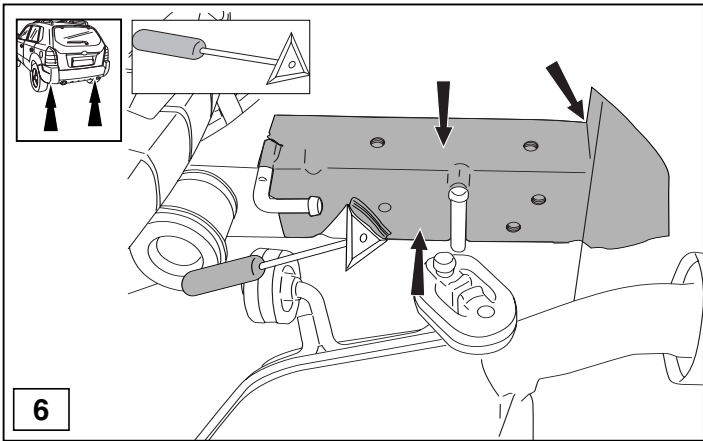

© 430370/20-05-2005/7

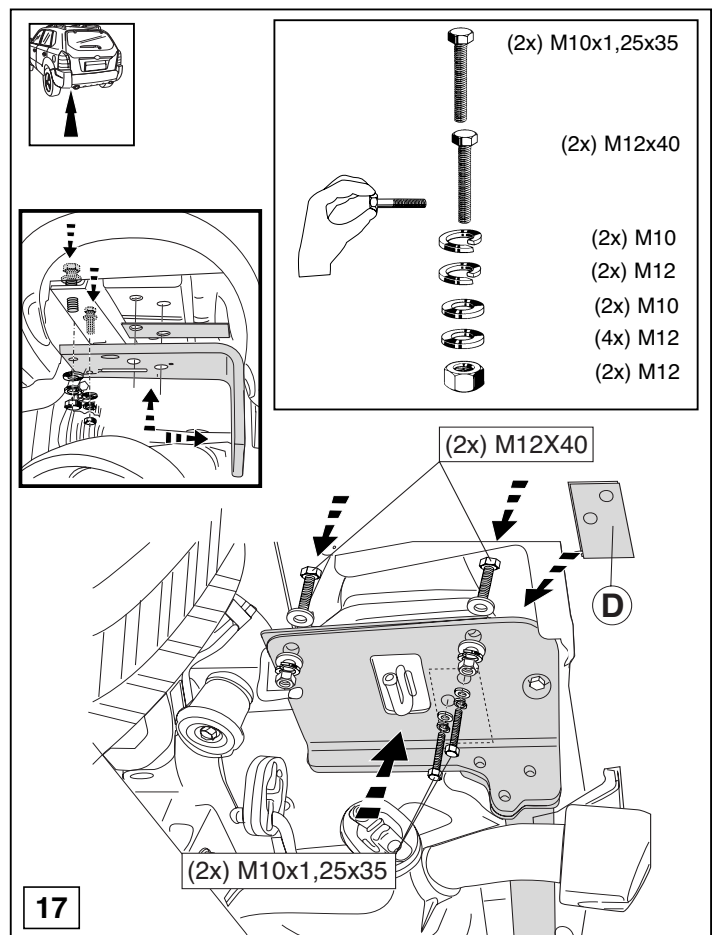
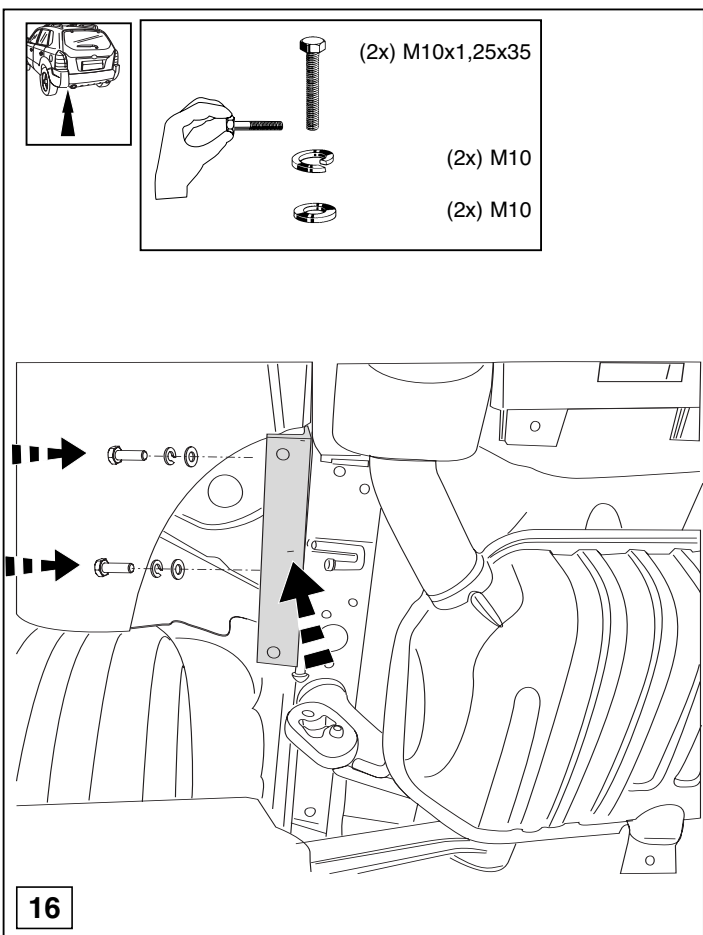

© 430370/20-05-2005/12



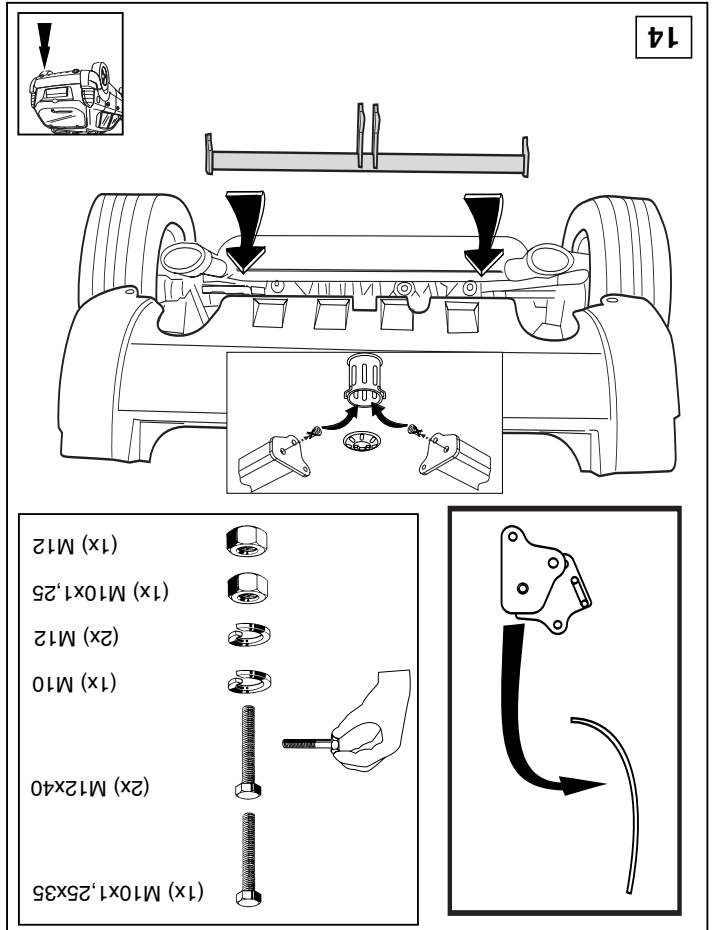
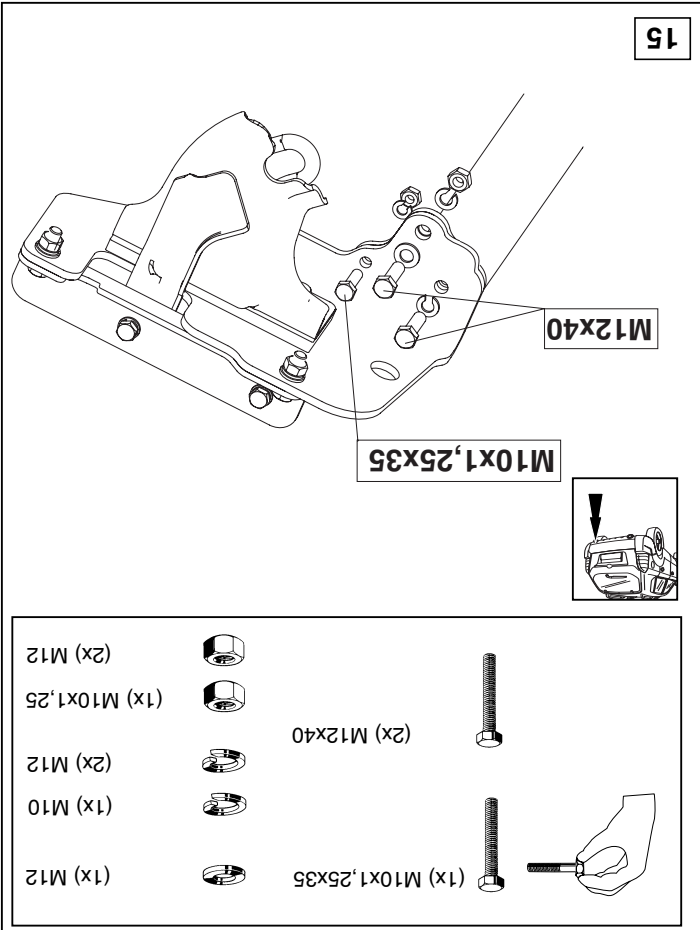
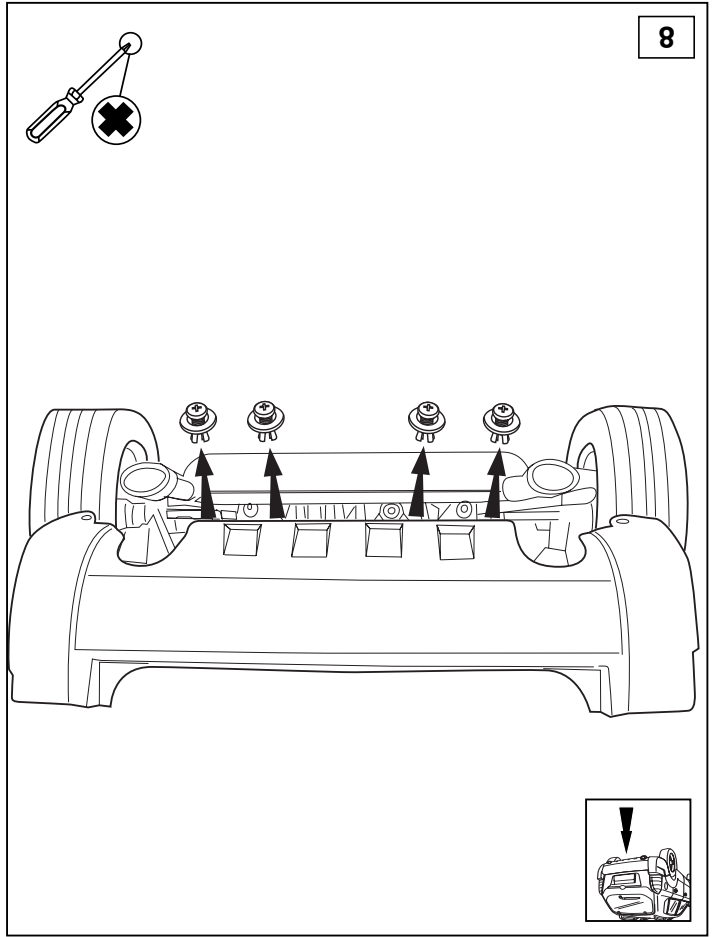
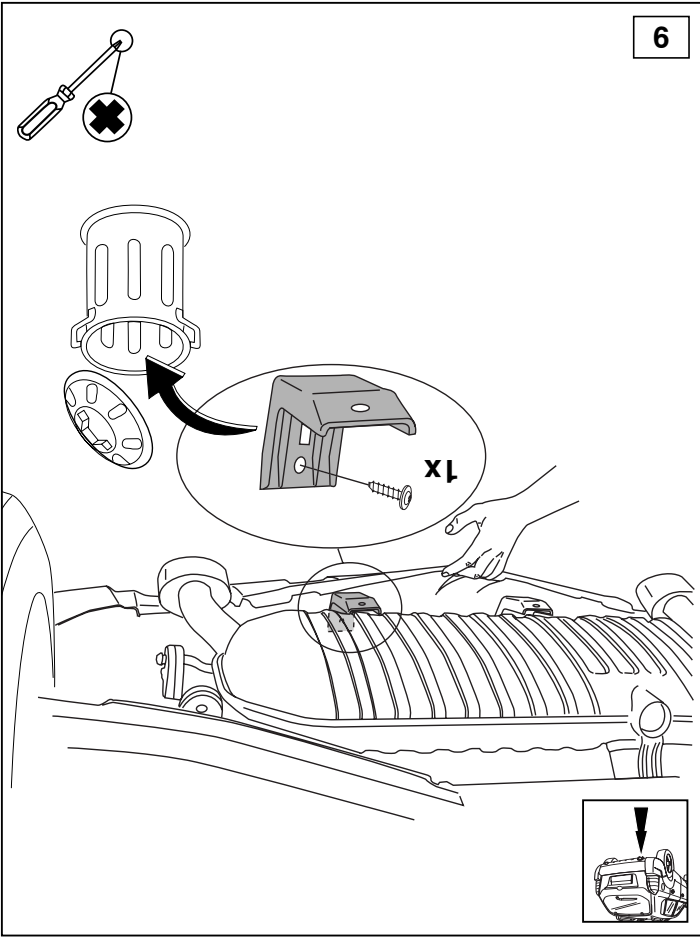

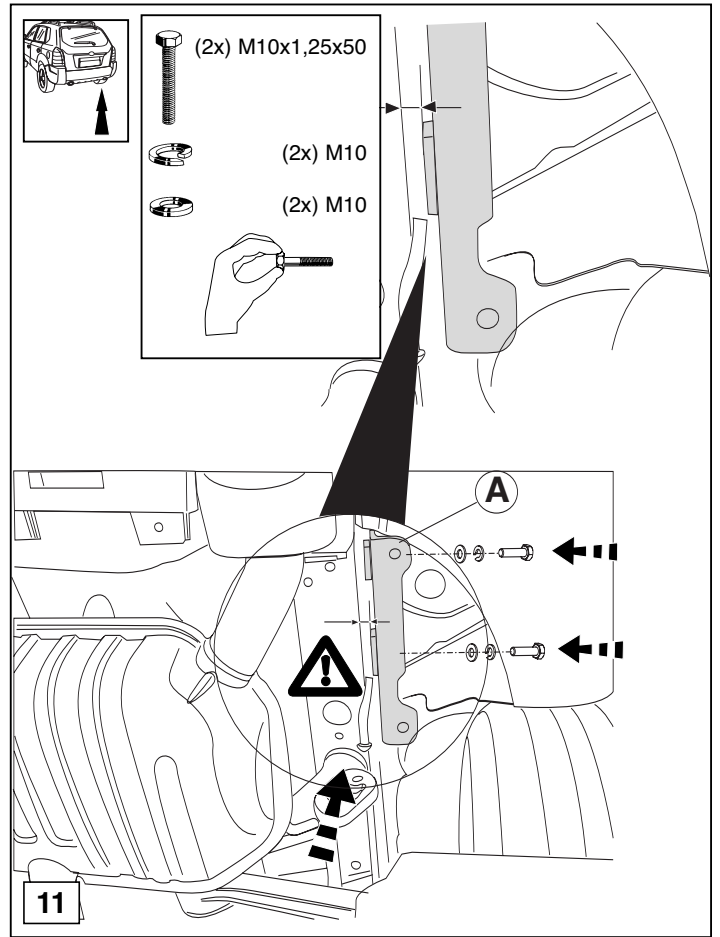
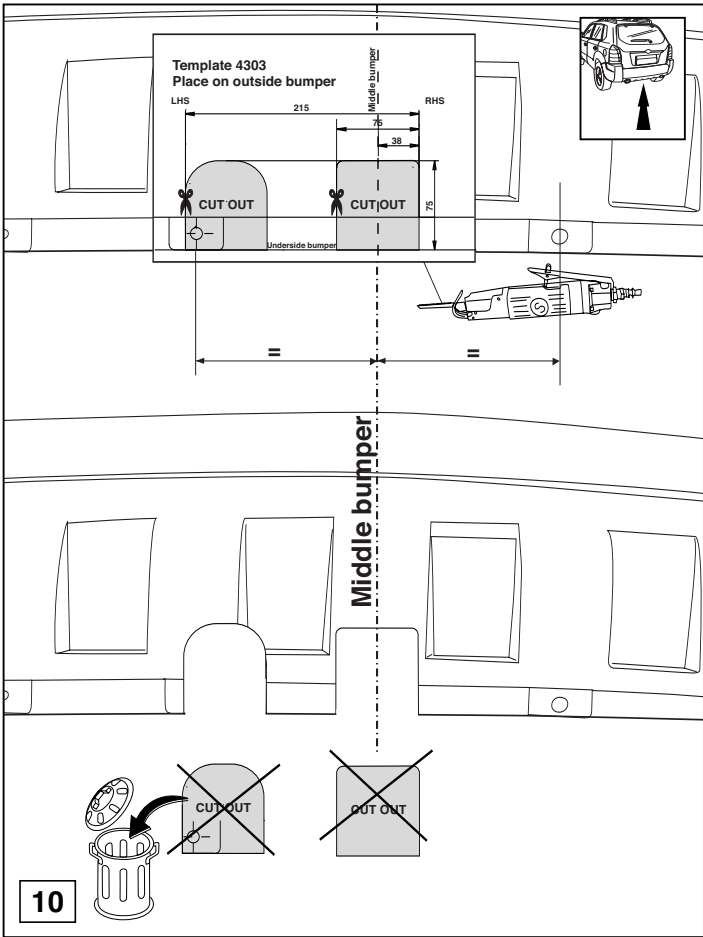

© 430370/20-05-2005/9

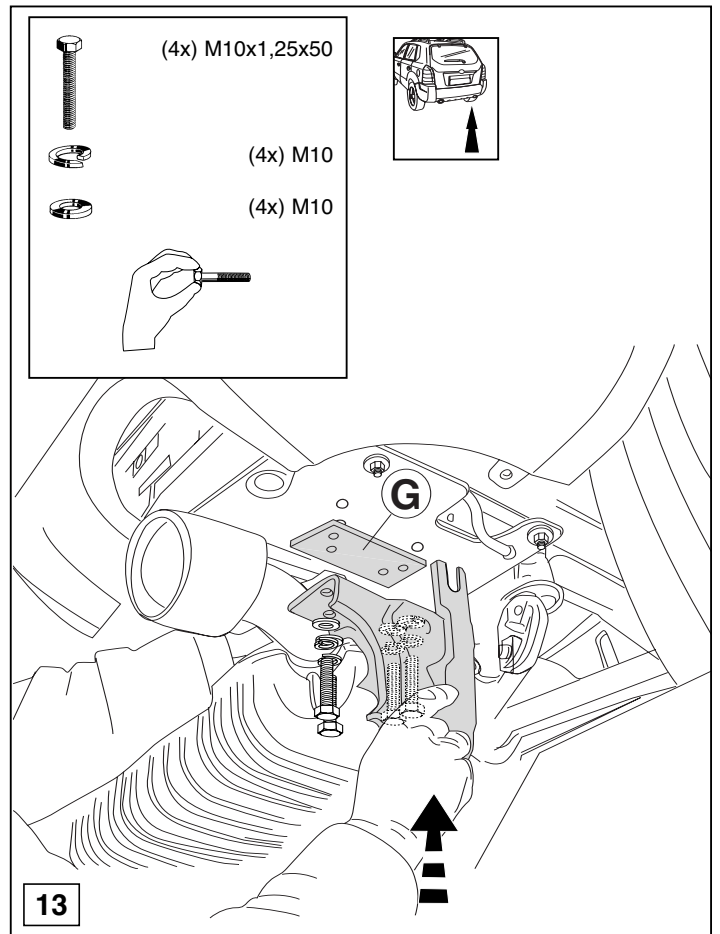
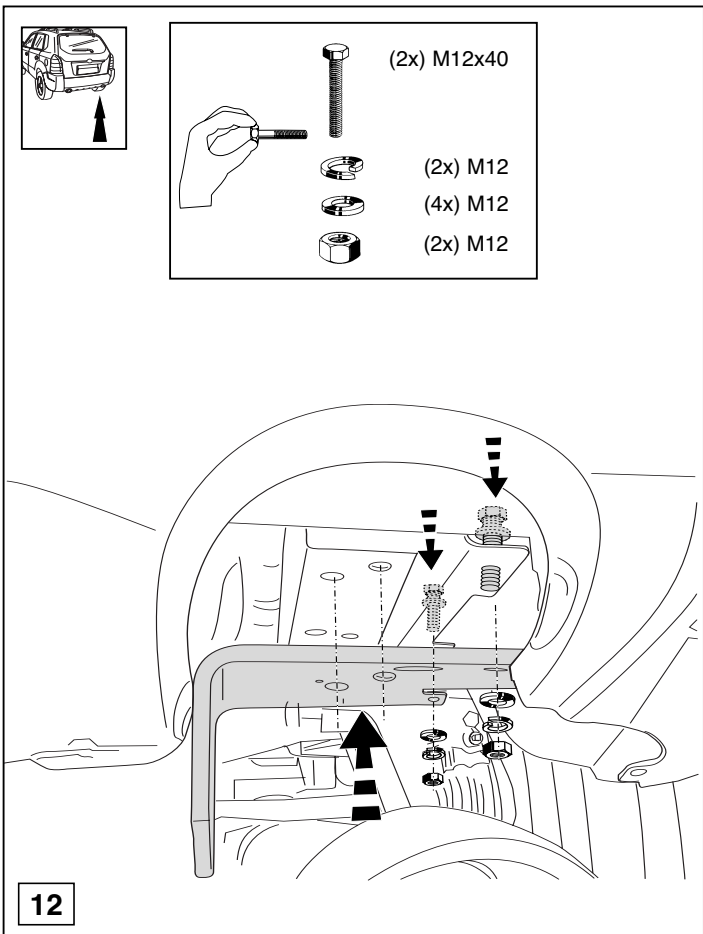

© 430370/20-05-2005/10



# Template 4303

## Place on outside bumper

LHS

215

Middle bumper

RHS

76

38

75

CUT OUT

CUT OUT

Underside bumper

